



Product Type: IP67 connector

Product Name:ESF-PS200A50B

Product Description:

### Product Size

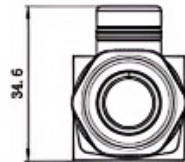
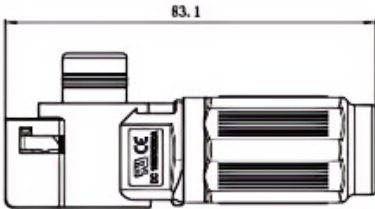

插头除键槽及类型标识不同外，其它结构均相同

订货号	物料名称	插头键槽	coding	备注
ESF-PS200A50Y	ESF-PS200A50Y 插头		无	橙色
ESF-PS200A50B	ESF-PS200A50B 插头			黑色
ESF-PS200A50Y-A	ESF-PS200A50Y-A 插头		A:20°	橙色
ESF-PS200A50B-A	ESF-PS200A50B-A 插头			黑色
ESF-PS200A50Y-B	ESF-PS200A50Y-B 插头		B:30°	橙色
ESF-PS200A50B-B	ESF-PS200A50B-B 插头			黑色

### Parameters

<input checked="" type="checkbox"/> SUPU ID	ESF-PS200A50B
<input checked="" type="checkbox"/> Number of connections	1
<input checked="" type="checkbox"/> Connection method	Crimp
<input checked="" type="checkbox"/> Protection Level	IP67

<input type="checkbox"/> Operating temperature range	-40°C~125°C
<input type="checkbox"/> Insulation material	PA
<input type="checkbox"/> Insulation material group	III
<input type="checkbox"/> Contact material	Copper alloy
<input type="checkbox"/> Contact plating	Ag,Plated
<input type="checkbox"/> Insertion/withdrawal cycles	100
<input type="checkbox"/> Insertion force	≤75N
<input type="checkbox"/> Withdrawal force	≥10N

## Technical data

<input type="checkbox"/> IEC Rated Current	150A
<input type="checkbox"/> IEC Rated Voltage	1500V
<input type="checkbox"/> Overvoltage category	III
<input type="checkbox"/> Degree of pollution	3
<input type="checkbox"/> Rated impulse voltage	12.3KV
<input type="checkbox"/> UL Rated Current	50mm <sup>2</sup> (AWG1/0)
<input type="checkbox"/> UL Rated Voltage	Negative
<input type="checkbox"/> Stripping length	20mm±1mm
<input type="checkbox"/> Rated cross section	50mm <sup>2</sup> (AWG1/0)
<input type="checkbox"/> Rated cross section(AWG)	35mm <sup>2</sup> (AWG2)
<input type="checkbox"/> External cable diameter	9.5mm~12mm

## Commercial data

<input type="checkbox"/> Order No	ESF-PS200A50B
-----------------------------------	---------------

<input type="checkbox"/> Packing unit	1
<input type="checkbox"/> Minimum order quantity	PCS
<input type="checkbox"/> Weight per unit (without packaging)	0.064KG
<input type="checkbox"/> Single piece weight	0.062KG

## Ningbo SUPU Electronics Co., Ltd.

Address: No. 150, Xinxing 4th Road, High-tech Industrial Development Zone,  
Cixi City, Zhejiang Province, China

Zip code: 315303

Switchboard: +86 574-63288158

Fax: +86 574-63288170

E-mail:supucontact@supu.cn

Service Hotline: 400-626-6336

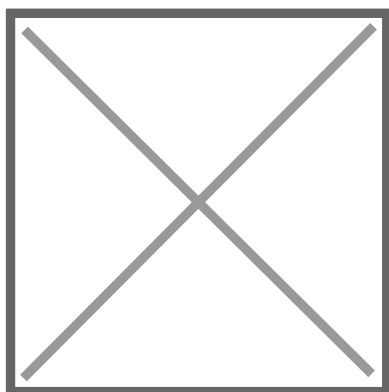

Wechat